

**Jetpik**  
**Model JP-51M/51/210/250-SOLO**  
**Power Floss System**

<b>1. Important safeguards.</b>	<b>1</b>
<b>2. Appliance description.</b>	<b>5</b>
<b>3. Getting started.</b>	<b>7</b>
<b>4. Care of your Jetpik unit.</b>	<b>12</b>
<b>5. Troubleshooting.</b>	<b>14</b>
<b>6. Limited warranty.</b>	<b>16</b>

## **1. Important safeguards.**

***Read all instructions before use***

### **Dangers**

To reduce the risk of electrocution:

- Do not immerse the charger in water or other liquids.
- Do not place or store the appliance where it can fall or be pulled into a bath, washbasin or sink.
- Check the main body of the charger and the cable regularly and if damaged, please replace.

### **Warning**

To avoid the risks of electric shock, personal injury or fire:

- Do not plug the charger into a voltage that is different from the voltage specified on the device or charger.
- The adapter for Jetpik is designed to work within a range of 100 to 240 AC Volts.

- The charger wire for Jetpik is designed to be linked to standard USB output which is 4.75 to 5.25 V DC. Please don't plug the charger to any other voltage that may cause damage to the equipment.
- Do not use this appliance if it has been dropped into water or other liquid and is not working properly. Contact Jetpik or your local dealer, which can be found at [www.jetpik.com](http://www.jetpik.com).
- Do not direct water and floss to any area other than your teeth and gums. This device delivers a pressurized water stream and moving floss that can cause serious damage on other tissues or body parts.
- Use this appliance only as shown in these instructions or as recommended by your dental professionals.
- Only use supplies and accessories that are manufactured or recommended by Jetpik.
- Use only water or other solutions recommended by Jetpik only. No alcohol based or bleach liquid should be used.
- Do not drop or insert any foreign object into any opening on the appliance.

- Do not use the adapter outdoors and never force the plug into a mains socket. If the plug does not easily fit into the socket, stop, don't use it and try an alternative socket or replace with a new adapter.
- This appliance contains no user-serviceable parts. Contact Jetpik or your local dealer for service if your Jetpik no longer works properly and needs repair.
- Use this appliance only for its intended use as described in this document or as recommended by your dental professionals.
- Jetpik is not intended for use by persons (including children) with reduced physical, sensory, or mental capabilities. Children should always be supervised and given instruction concerning the use of this appliance by a person responsible for their safety.
- Jetpik is a personal care device and is not intended for use on multiple patients or in a dental practice or institution.
- Children should always be supervised to ensure that they do not play with the appliance.
- Avoid applying excessive pressure to the nozzle. Do not block the water stream by pressing the nozzle to the gum while cleaning as this may cause damage to the motor.

## **Medical Warning**

- Consult your dental professional before using this appliance if you have had oral or gum surgery in the preceding two months.
- Contact your dental professional if excessive gum bleeding occurs after using this appliance or if bleeding continues to occur after one weeks use.
- Discontinue using Jetpik and contact a physician/dentist if discomfort or pain is experienced.
- Consult your physician if you have any other medical concerns.

***Save These Instructions***

## 2. Appliance Description.

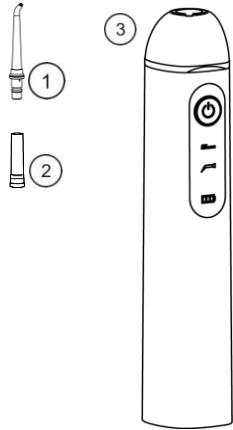

JP51M

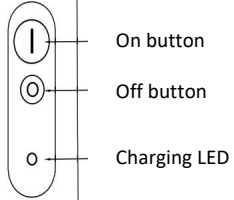

On button  
Off button  
Charging LED

LED Display

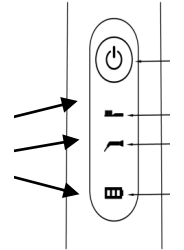

On/off button  
Brush (JP2xx only)  
Nozzle  
Battery LED

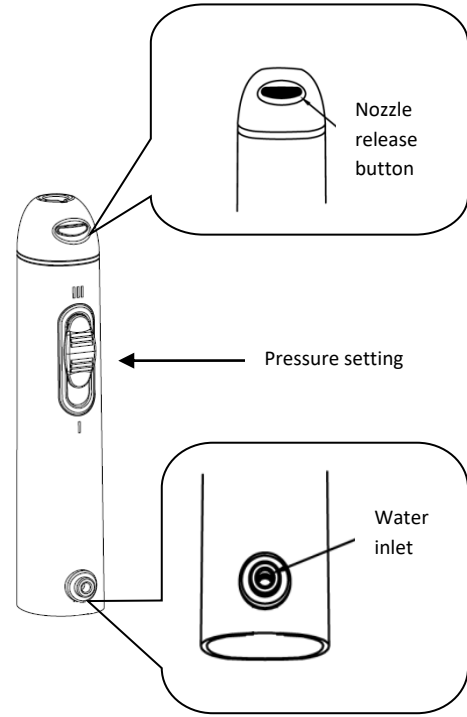

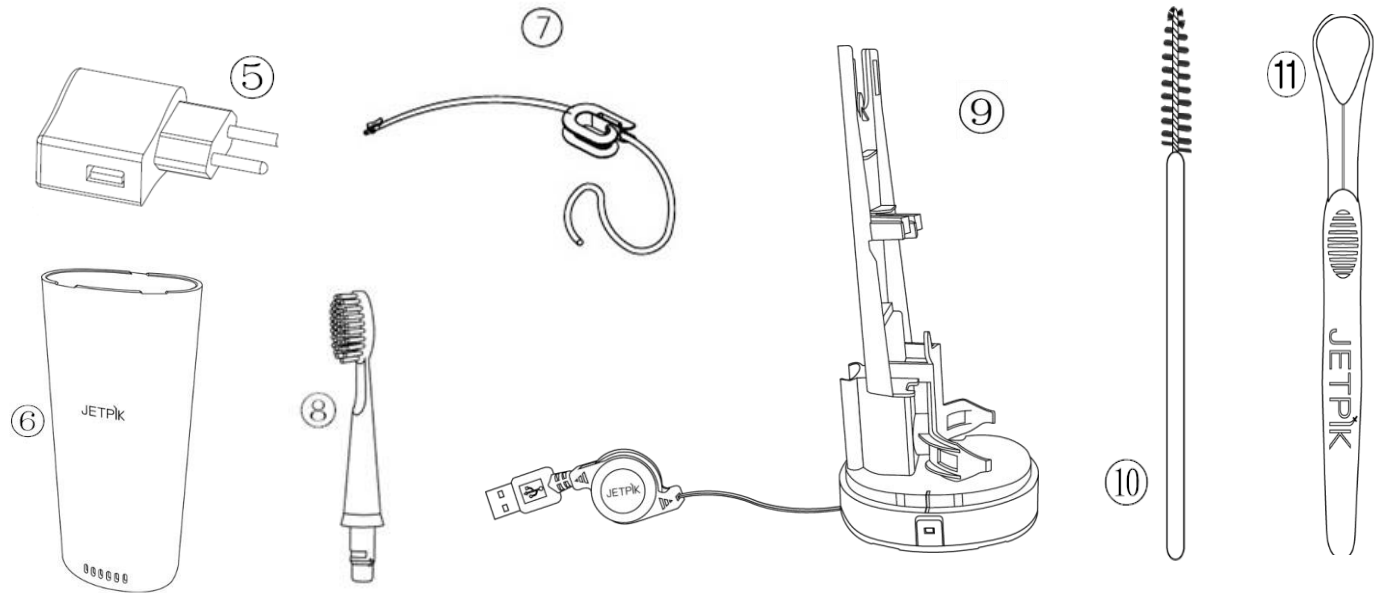



- ① Nozzle ② Floss capsule ③ Handle ⑤ AC Adapter ⑥ Travel lid ⑦ Water supply tube ⑧ Power toothbrush tip (JP2XX-Solo only)  
⑨ Charging base and Holder ⑩ Contacts cleaning brush(JP2XX-Solo only) ⑪ Tongue cleaner ( JP2XX-Solo only)

### 3. Getting Started.

**Initial Battery Charging:** Initial charge of Jetpik should be 2 to 6 hours based on the battery pre-charging status. To do so just keep the handle on the base in the docking position and pull the cable out from the bottom chamber and connect other USB side to your adapter and plug the adapter to your mains. A steady LED light on the panel of the handle will indicate that the power is on and the unit is charging. Usually it will take less than 8 hours for the battery to be fully charged after the complete discharge.

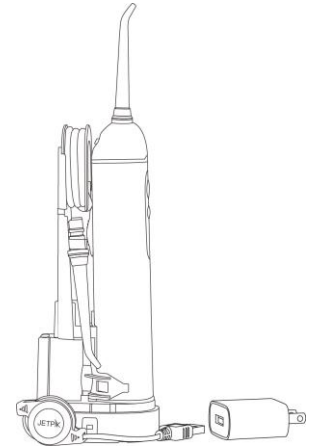

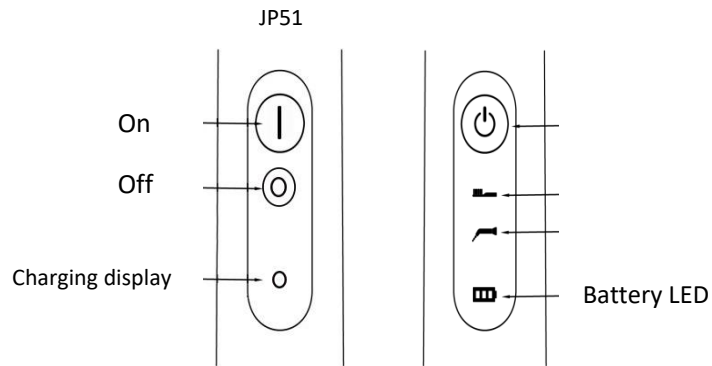

### **Indication of battery status (JP51M-Solo doesn't have this display)**

Every time the unit is turned on and turned off, the battery LED will flash. Flashing 4 times means the battery is full; 3 times meaning the battery is around 80%, 2 times meaning around 50%, and one time meaning less than 20%. It is recommended that you charge your unit when it flashes only once.

## Preparing Jetpik for Use

### Before using:

- ① Place one floss capsule into the nozzle (Note that Jetpik will not work properly without the floss capsule in position and you don't need to replace it but must have one in the nozzle). Fig 1
- ② Clip the nozzle into the handle and latched firmly. Fig 1
- ③ Insert the quick connector on one side of the water supply tube to the Jetpik handle water inlet.
- ④ Use the spool of the water supply tube to clip the other end of the tube into a cup or bottle of water or you can use the lid as your cup. Note –To ensure that the tube remains fully immersed beneath the surface of the water. (see below Figure 2)

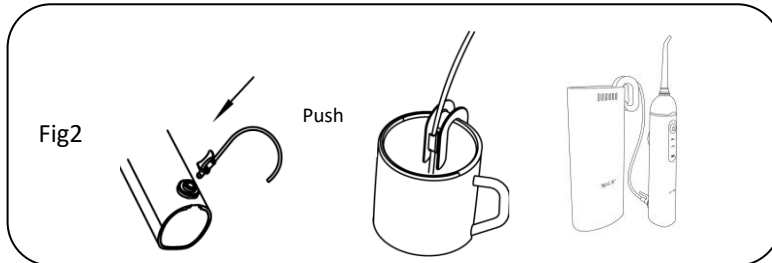
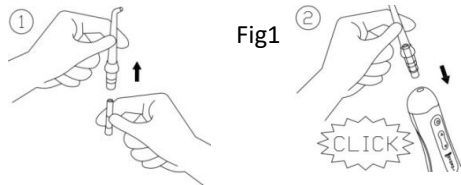

**Prime the floss:**

Press and move the pressure adjust button to the top III(+) position, aim the nozzle into the sink and press the On/Off button. Wait a few seconds until the water projects from the nozzle and the string floss begins pulsating from the capsule. Once done, turn off the unit by pressing the On/Off button again.

**Using**

If you have never used a water irrigator before, it is recommended to start at a lower setting by adjusting the pressure adjust button to the “-“position. You can gradually increase the pressure provided you don’t experience any gum bleeding or discomfort.

To begin, lean over the sink, place the nozzle into your mouth, position the tip towards your teeth and press the On/Off button. Direct the jet stream onto your gum-line as illustrated and move from one tooth to another. Slightly close your lips to avoid splashing but allow water to flow freely from your mouth to the sink. For best results, pause briefly between teeth to let the floss fully clean the area.

Continue until all areas around and between the teeth have been reached. It is recommended that you replace the floss capsule every other week to get the best cleaning results under the gum-line, behind any braces and between the teeth.

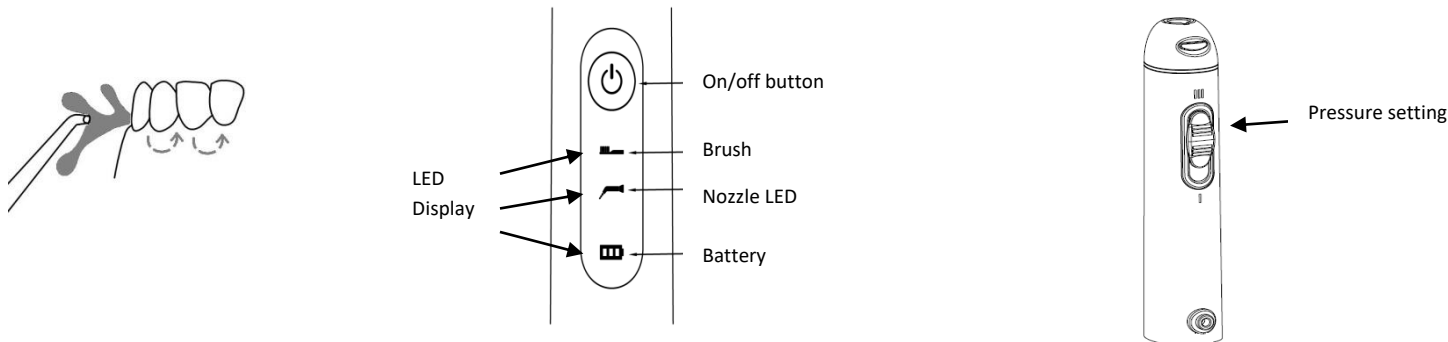

### Using the Power brush function (Option for JP2XX-Solo models only)

1. Clip the power toothbrush head to your Jetpik handle as shown. If you have the jet nozzle attached, you will have to replace it with the brush head.
2. Apply a comfortable amount of toothpaste onto the brush and make contact with your teeth surface. Press the On/Off button to start the power brush.

3. Pressing the On/Off button once will give you the highest strength in toothbrush power. Pressing the On/Off button a second time will give you a lower strength interval.
4. Pressing the On/Off button a 3rd time will turn the power brush off.
5. At the end of a 2 minutes session the brush will give 3 pauses to notify you regarding the recommended time.

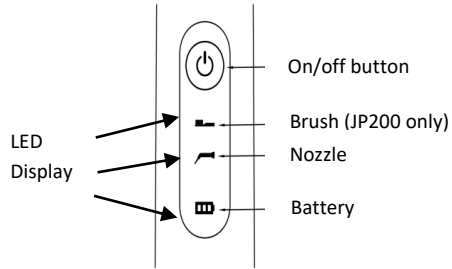
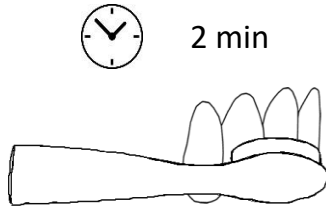

**6. Embedded UV/ Ozone Sanitizer :**

JP250-Solo has a build in UV/Ozone bulb that can give you 10 minutes sanitizing when you have the lid closed and USB power connected. This is the best tool to destroy germs and molds that may hide inside the brush bristles and water tube.

#### **4. Taking care of your Jetpik unit.**

1. Always empty the lid and keep your Jetpik dry if it is not going to be used for a length of time.
2. Use tap or pure water to rinse out your unit if you have used it to deliver mouthwash or antibacterial solutions.
3. Turn on the unit for few seconds to let the remaining water empty before you put the unit into the travel case.

#### **Disposal**

When the appliance reaches the end of its life cycle, please remove the rechargeable battery from the handle prior to disposal by puncturing and opening the plastic cover. Once opened, cut the wires attaching the battery to the handle and recycle or dispose of the battery based on your local regulations. The rest of the unit can be discarded appropriately. N.B. Batteries must not be included with normal household waste and should be taken to proper collection points to comply with Directives 2002/96/EC and 2006/66/EC.

Penalties may be applicable for incorrect disposal of this appliance.

## 5. Troubleshooting Guide

<b>Problem</b>	<b>Cause</b>	<b>Corrective action</b>
Jetpik is turned on but no water is coming out of the nozzle.	<ol style="list-style-type: none"><li>1. There is no floss capsule in nozzle or the capsule is too old to function.</li><li>2. The water supply tube is clogged.</li><li>3. The nozzle was not fully engaged.</li></ol>	<ol style="list-style-type: none"><li>1. Insert a new capsule into the nozzle and prime it.</li><li>2. Flush out the tube or replace it.</li><li>3. Release and re-install the nozzle.</li></ol>



<p>Jetpik doesn't start.</p>	<p>Battery is not charged. Battery LED is displaying the status.</p>	<p>Be sure the power adapter is functioning and the battery LED is on when charging cable is connected. Fully charge for over 6 hours and try again. When the LED is flashing the on/off button is no function</p>
<p>Power toothbrush is not running when brush tip is inserted. Instead, the handle pump motor is running.</p>	<ol style="list-style-type: none"> <li>1. Brush tip is not in position.</li> <li>2. Contact points between the brush tip and the handle are not clean.</li> <li>3. Brush motor is dead.</li> </ol>	<p>Pull out the brush tip and use a swab or Jetpik cleaning brush (included) to clean the contact points. Once cleaned, reinsert the brush tip into the handle or replace the brush tip.</p>

## **6. Limited Two-Year Warranty**

Jetpik is warranted to the original consumer to be free from defects in materials and workmanship for 2 years from the date of purchase. Consumers will be required to submit the original purchase receipt and the entire appliance to support a warranty claim. Jetpik will replace, at its discretion, any part of the appliance which is deemed to be defective, provided the product has not been abused, misused, altered or damaged after purchase, was used according to the provided instructions, and was used only with accessories or supplies approved by Jetpik. Correct use and installation is the responsibility of the consumer and is not covered by the warranty. This limited warranty excludes accessories and supplies such as, but not limited to, nozzles, floss capsules and brush heads.

## **Limitation of Remedies**

In no circumstance shall Jetpik or any of its affiliated or subsidiary companies be liable for any special, incidental or consequential damages based upon breach of warranty, breach of contract, negligence, tort, or any other legal remedy. Such damages include, but are not limited to, loss of savings or revenue, loss of profit, loss of use, the claims of third parties including, but not limited to, dentists and dental hygienists, and the cost of any substitute equipment or services.

## **Jetpik®**

[www.jetpik.com](http://www.jetpik.com) ; email contact: sales@jetpik.com

Jetpik® is a trademark of Nucreatronics Electronic Technology (Shanghai) Co.,LTD. registered in USA, Europe, Brazil, China and other countries.

### **Headquarters Jetpik USA:**

Add: 16453 Old Valley Blvd. City of Industry, CA 91744, USA.

Tel: +1 626-330-0808

### **Jetpik China:**

Add: 201 Jin Xiang Lu, Building 1 Room 812. Shanghai 201204, China

Tel: +86 21 50116663